

3700 Division Street
3700 Division Street
Saint Cloud, MN 56301

Your Sign

For Lease

2,166 SF Suite available in this professional office building. The 3700 Building is situated on the corner of Highway 15 and Division Street offering exceptional visibility and exposure from the busiest intersection in Saint Cloud. This professional office building is handicap accessible, many exterior windows, and pylon sign, building signage and an electronic reader board for fantastic visibility.

Property Features:

Total SF:	9,420 Total SF
Parking:	40+ Shared Surface Parking
Traffic:	34,000+ AADT
Management:	Locally Managed Property
Lease Rates:	\$17 SF Gross
Signage:	Building, Electronic Reader Board and Pylon

For more information contact:

Matt Studer
320.251.9300
mstuder@warnert.com

Sheila DeVine
320.251.9300
sdevine@warnert.com

Retail Space

Suite 110

Max Contiguous:	2,166 SF
Minimum Divisible:	2,166 SF
Rent/SF/Year	\$17 SF Gross
Term:	Negotiable
Occupancy:	Vacant
Visibility:	High
Date Available:	Immediately



Floor Plan

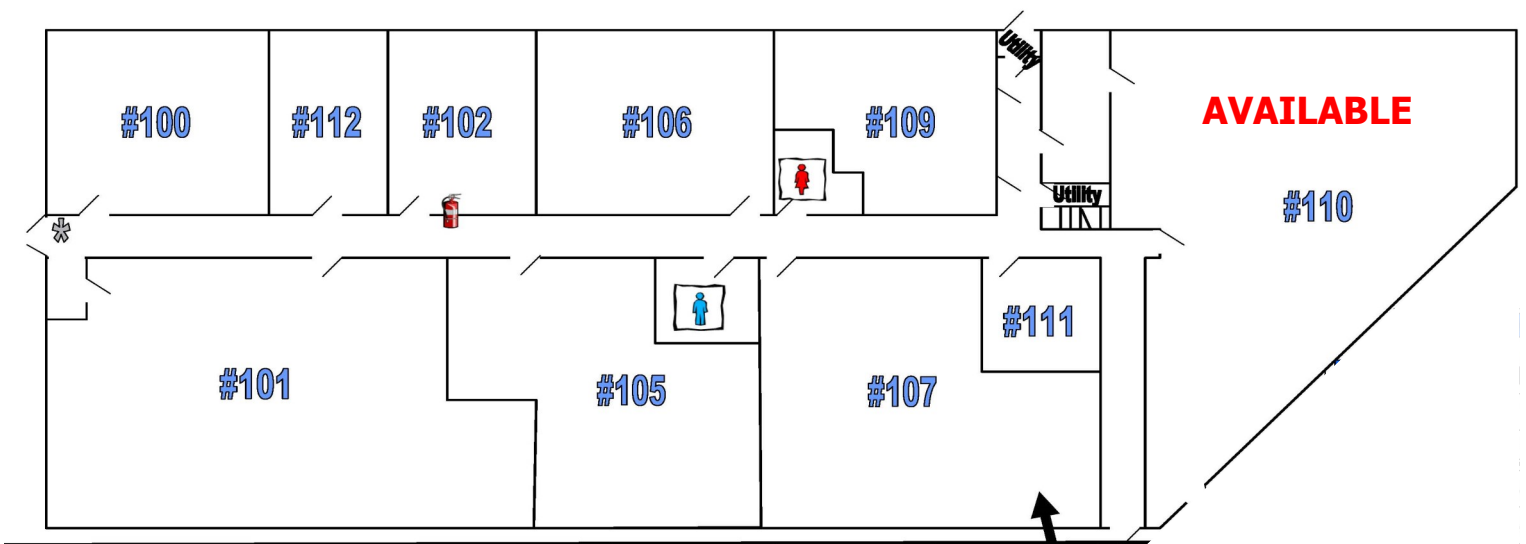

For more information contact:

Matt Studer
320.251.9300
mstuder@warnert.com

Sheila DeVine
320.251.9300
sdevine@warnert.com

Aerial View



Traffic

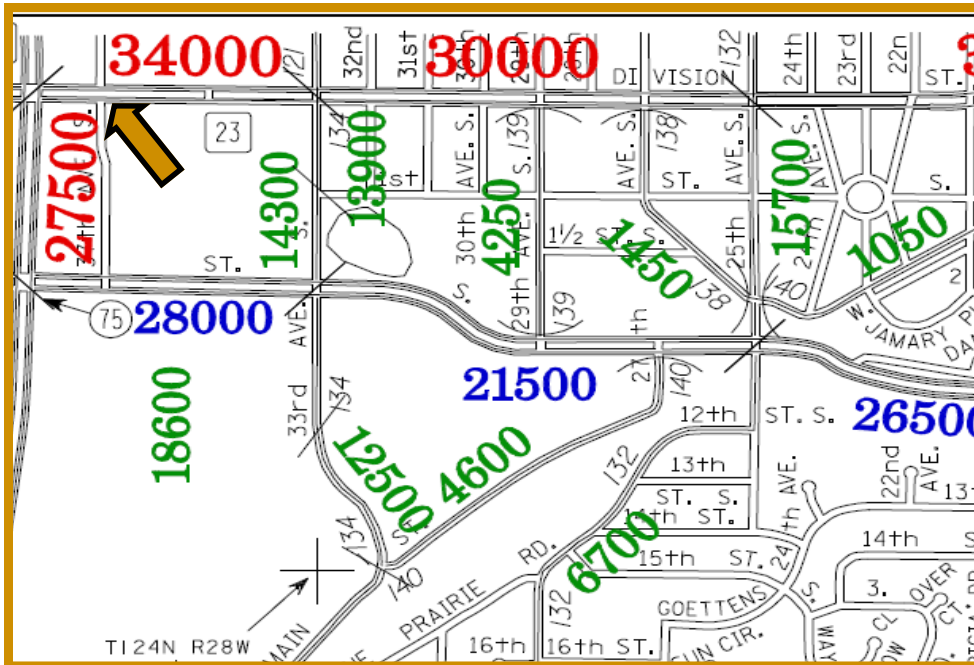

For more information contact:

Matt Studer
320.251.9300
mstuder@warnert.com

Sheila DeVine
320.251.9300
sdevine@warnert.com